

# Owners Manual

Product Code: 1030

**MADE FOR THE  
TRADE**

**TQ TRADEQUIP**  
the trusted brand in equipment

## ENGINE CRANE LOAD LEVELLER



### Specifications:

- Safe Working Capacity: 680kg
- Chain Length: 300mm
- Chain Anchor Positions: 3
- Engine Mount Positions: 4
- Weight: 6kg
- Carton: 465 x 190 x 60mm

### About the TradeQuip brand

The 'TradeQuip' brand of workshop equipment, is designed for use in a demanding workshop environment by professional users. With proven and trusted "Made for the Trade" reliability, 'TradeQuip' branded products offer the very best in performance for an affordable price. All backed by a 1year trade guarantee across 1,000+ distributors Australia wide.

**TQ TRADEQUIP**  
the trusted brand in equipment

**TQPRO**  
Trusted by various professionals

**BORUM**  
INDUSTRIAL WORKSHOP EQUIPMENT

**WARNING INFORMATION**

**IMPORTANT: READ ALL INSTRUCTIONS BEFORE USE**



**WARNING**

The instructions and warnings contained in this manual should be read and understood before using or operating this equipment. Do not allow anyone to use or operate this equipment until they have read this manual and have developed a thorough understanding of how this equipment works. Failure to observe any of the instructions contained in the manual could result in severe personal injury to the user or bystanders, or cause damage to the equipment and property. Keep this manual in a convenient and safe place for future reference.

Whilst every effort has been made to ensure accuracy of information contained in this manual, the TQB Brands Pty Ltd policy of continuous improvement determines the right to make modifications without prior warning.

**CONTENT**

WARNING INFORMATION ..... 2

CONTENT ..... 2

STANDARD OPERATING PROCEDURE ..... 3

ASSEMBLY, OPERATION, PREVENTITIVE MAINTENANCE ..... 4

PARTS DIAGRAM ..... 5

PARTS LIST ..... 5

WARRANTY ..... 6

## STANDARD OPERATING PROCEDURE

**DO NOT** use this machine unless you have been trained and assessed to a competent level in its safe use and operation, and have been given permission to use this



DO NOT tilt the unit



Wear the correct PPE

### PRE-OPERATIONAL SAFETY CHECKS

- Before using the engine-transmission leveller ensure it is in sound condition, and good working order.
- Replace or repair damaged parts. Use recommended parts only. Non-authorised parts may be dangerous and will invalidate the warranty.
- Keep the engine-transmission leveller clean for best and safest performance.
- Locate the engine-transmission leveller in an adequate working area for its function, keep area clean and tidy and free from unrelated materials, and ensure there is adequate lighting.
- Maintain correct balance and footing. Ensure the floor is not slippery and wear non-slip shoes.
- Ensure all non-essential persons keep a safe distance whilst the engine-transmission leveller is in use.
- Lock all knobs securely in position before fixing a load, and ensure the load is centred across the engine-transmission leveller.
- Always ensure the engine-transmission leveller and the load is stable.
- DO NOT operate unit if damaged.
- DO NOT allow untrained persons to operate the engine-transmission leveller.
- DO NOT exceed the rated capacity of 680kg.
- DANGER: DO NOT work under a loaded engine-transmission leveller.

**This Product is designed specifically to be used with**

**Product Code: 1001 Engine Crane**



### INTENDED USE

For regular professional use, to raise and/or lower passenger car engines and transmissions during service or repair work.

## ASSEMBLY, OPERATION, PREVENTITIVE MAINTENANCE

### 1. FEATURES

The 1030 680kg engine-transmission leveller accepts a wide variety of engines and transmissions. This engine-transmission leveller comes with everything needed to perform work on your engine or transmission, including a steel beam, adjusting screw, steel chains with brackets, hooks and hardware. The engine-transmission leveller is specially designed to tilt the engine and/or transmission for easy removal/installation of most engines and transmissions.

### 2. BEFORE USE

Prior to each use conduct a visual inspection by checking for abnormal conditions, such as cracked joints and damaged, loose, or missing parts.

### 3. OPERATING INSTRUCTIONS

1. ALWAYS refer to the vehicle owner's manual of the engine/transmission to be lifted to determine the lifting points.
2. Park the car on a flat surface, apply the parking brakes and chock the wheels.
3. Never try to move a running or hot engine. Allow sufficient time for the engine to cool down entirely before beginning any operations.
4. Position the crane, chain block or hoist above the engine bay of the car.
5. Securely connect the mounting loop to the hook on the crane, chain block or hoist.
6. Centre the engine-transmission leveller assembly over the engine.
7. Attach the chain brackets to the engine at the appropriate lifting points.
8. Operate the crane, chain block or hoist until the chains are taut and the engine/transmission is held securely on all four brackets.
9. Loosen engine mounts. Adjust load height until the entire engine's weight is supported by the chains. Continue to loosen and disconnect the engine/transmission mounts.
10. Turn the Screw Handle clockwise adjust the angle to the best position for the engine/transmission to be removed or installed.
11. Never work on the engine while it is supported only by the engine-transmission leveller.
12. Moving the engine whilst it is suspended only by the Engine Support Bar can cause the engine-transmission leveller to fail or shift, resulting in serious personal injury and/or property damage.
13. To prevent accidents, lower and reconnect the engine when finished working. The engine-transmission leveller is not intended to be used as a long-term suspension device.
14. Clean, then store the tool indoors out of children's reach.

### 4. STORAGE

This engine-transmission leveller should always be stored in a dry location on a level surface.

### 5. MAINTENANCE

Replace or repair damaged parts. Use recommended parts only. Non-authorized parts may be dangerous and will invalidate the warranty.

Keep the engine-transmission leveller clean for best and safest performance.

### 6. SERVICE & REPAIR

Any engine-transmission leveller found damaged in any way, or found to be worn or operates abnormally should be removed from service until repaired by an authorised service agent. Owners and / or operators should be aware that repair of this product may require specialised equipment and knowledge. Only authorised parts, labels and decals shall be used on this equipment. Annual inspection of the engine stand is recommended and can be made by an authorised repair facility to ensure that your equipment is in optimum condition and that the equipment has the correct decals and safety labels specified by the manufacturer.

## PARTS DIAGRAM

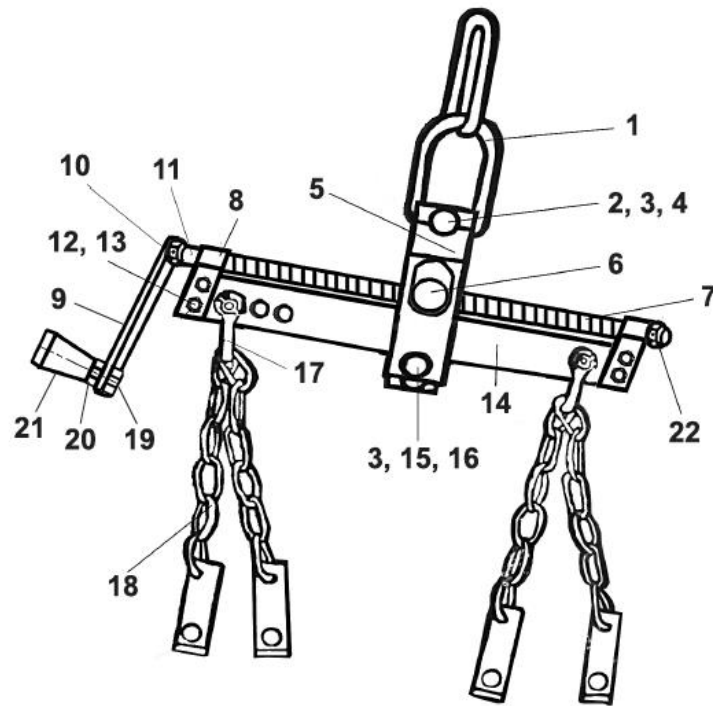

## PARTS LIST

Part	Description	Qty
1	Lifting Chain	1
2	Bolt M12 x 40	1
3	Lock nut M12	2
4	Washer	1
5	Connecting Plate	2
6	Sliding Block	1
7	Threaded Bar	1
8	Connecting Plate	2
9	Crank Arm	1
10	Spring Pin	2
11	Washer	1

Part	Description	Qty
12	Bolt M10x25	4
13	Lock Nut M10	4
14	Cross Beam	1
15	Bolt M12x45	1
16	Washer	1
17	Shackle	2
18	Chain/Bracket Set	4
19	Bolt M10x35	1
20	Nut M10	1
21	Handle	1
22	Nut M6	1

## WARRANTY

Tradequip products have been carefully tested and inspected before shipment and are guaranteed to be free from defective materials and workmanship for a period of 12 months from the date of purchase except where tools are hired out when the guarantee period is ninety days from the date of purchase.

Should the machine develop any fault, please return the complete tool to your nearest authorised warranty repair agent or contact TQB Brands Pty Ltd Warranty team – [warranty@tqbbrands.com.au](mailto:warranty@tqbbrands.com.au).

If upon inspection it is found that the fault occurring is due to defective materials or workmanship, repairs will be carried out free of charge. This guarantee does not apply to normal wear and tear, nor does it cover any damage caused by misuse, careless or unsafe handling, alterations, accident, or repairs attempted or made by any personnel other than the authorised TQB Brands Pty Ltd repair agent.

This guarantee applies in lieu of any other guarantee expressed or implied and variations of its terms are not authorised.

Your TQB Brands Pty Ltd guarantee is not effective unless you can produce upon request a dated receipt or invoice to verify your proof of purchase within the 12month period.

### Consumer Guarantee

Our goods come with a guarantee that cannot be excluded under the Australian Consumer Law. You are entitled to a replacement or refund for a major failure and compensation for any other reasonably foreseeable loss or damage. You are also entitled to have the goods repaired or replaced if the goods fail to be of acceptable quality and the failure does not amount to a major failure.



All images and illustrations shown are for reference purposes only. All information, specifications and illustrations in this manual are based on the latest information available at the time of publication and are subject to change without notice. The information in this manual is periodically revised to ensure the latest information is included. Download the latest version of this manual and other related technical documentation from [www.tqbbrands.com.au](http://www.tqbbrands.com.au).